

**Timeline:**

- 1868 Land selected, owned by Henry Smith. (Had to get his permission to bury someone there.) There were 15 bodies buried there when he got the land. (His house was completed in 1886.
- 1870 City of Wichita / Sedgwick County Incorporated. Became known as the "City Cemetery".
- 1870 Sept. 1870 Frank H. Allen (son of J. P. Allen) first white child born in Wichita, dies (2 mo. old) Plot donated by the Town Company.
- 1872 Cemetery platted. Wichita Cemetery Company formed. Several burials were made before 1872.
- 1872 Named "Highland Cemetery"
- 1885 Anna Arnstein (3 yrs) Stillborn baby (1887) Holy Emmanu-El (Reform) formed (Now: Congregation Emanu-El-1928. New building at 2<sup>nd</sup> and Fountain 1932.) Jewish Cemetery at Highland started.
- 1899 Highland Cemetery purchased from Smith by stock holders of Maple Grove Cemetery. Highland Cemetery Improvement Association formed. (Fund raising efforts in 1906 and 1948.)
- 1908 Ownership transferred to a 'lot owners' association, due to illegal "for profit" status.
- 1913 Mausoleum contracted at the SE corner. (George Saxton.) Completed 1916.
- 1924 Section 5 annexed.
- 1945 Parcels at Highland Cemetery and Old Mission Cemeteries up for auction, for back taxes.
- 1982 Last lots sold. The Wichita Cemetery Company abandoned Highland on July 1, 1982. City Council assumes responsibility for Highland under KSA 13-14c01 on Sept 21, 1982.
- 2012 The Historic Wichita Board oversaw the Cemetery thereafter. This board was dissolved in 1987. The Public Works / Park Department now reports to the Historic Preservation Board.
- 2012 6 headstones found near Haysville, for the Steele and other families.
- 2016 Friends of the Wichita Pioneers incorporated.



Barb Myers can be found on Facebook:  
**Wichita History From My Perspective  
 & Friends of the Wichita Pioneers**

*Myers is the author of "Walking With the Wichita Pioneers"  
 and co-author of "Old Cowtown Museum History."*

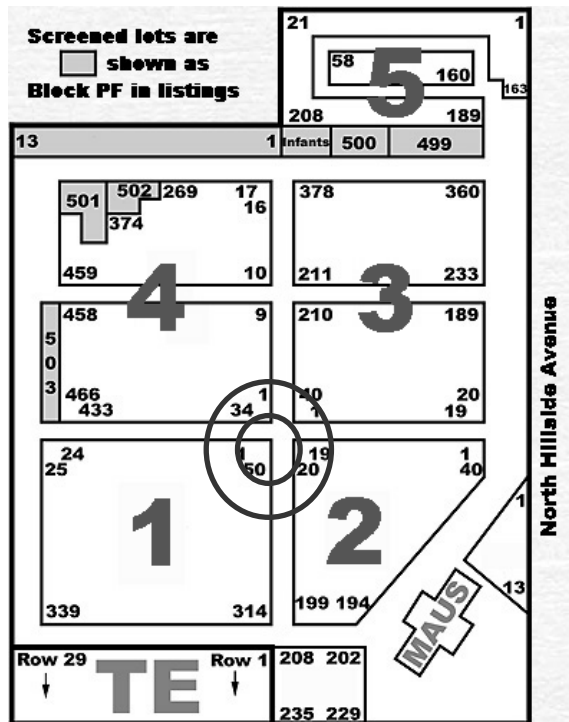

**Special thanks** to Bill Pennington,  
 whose research appears on the website:

<http://ksgeoweb.com/sedgwick/cems/highcem.html>

**And to:**

- Findagrave & Ancestry
- Wichita Sedgwick County Historical Museum
- The Kansas African American Museum
- The City of Wichita
- Kansas State Historical Society
- Old Cowtown Museum
- Midwest Historical Genealogical Society
- Wichita State University Special Collections



# HIGHLAND CEMETERY

## HISTORICAL TOUR

**1005 N. HILLSIDE  
 WICHITA, KANSAS**

**FRIENDS OF THE WICHITA PIONEERS  
 BARB MYERS, PRESIDENT  
 501 (C) (3)**

For more information, please contact  
 Barb Myers, President  
 316-371-7254  
 B\_myers123@live.com

### How many people are buried at Highland?

Over 17,225 people are buried at Highland.

### Do they still bury people at Highland?

Only if the land is already purchased. Plots are no longer sold.

### Who was the first person buried here?

That 's hard to answer because:

- There were as many as 15 bodies on the land, when Henry Smith took possession in 1868.
- Albert Lewellen – Died and was buried there before Wichita was incorporated (1868). He was the son of Doc Lewellen.
- Frank Allen – First “white” child born in Wichita, as opposed to indian, died and was buried here in 1870. He was the son of city founder J.P. Allen. His gravesite was donated for this purpose by the Town Company.

### Who is in the Mausoleum? Includes:

- Harry Dockum
- Charles Lock Davidson
- LW Clapp
- Henry Schweiter
- Ben Eaton
- Henry Lassen
- SO Naftzger (Family is also interred at Maple Grove)
- Ola Martinson
- Henry Clay Sluss
- Margaret Brown Innes (Family is also interred at Old Mission)

The Mausoleum is only open on Christmas Day and Memorial Day weekend.

### I have heard that some people were moved?

Yes. For example, after the Old Mission Mausoleum was built, the family of Marshall Murdock was moved to that mausoleum.

### Are there any “Indians”?

We know of two people who are at least 1/4 Native American who are buried at Highland: Catherine Burnett Greiffenstein and Lucy Riley Greenway.

### So who is buried here?

#### Section 1:

- Joseph P. Allen
- Mike Meagher and the Steele children
- Albert Lewellen
- Fred Sowers
- Nathaniel English
- William “Dutch Bill” Greiffenstein
- Jack Ledford
- Edwin “Red” Beard
- John Noble
- William “Buffalo Bill” Mathewson
- Lucy Inman Mead
- Hoover family (Hoover Orchard)
- John J. Jones (Jones 6)

#### Section 2:

- Christian Kimmerle
- Fritz Schnitzler
- Albert Jewett
- Thomas and Katherine Masterson and their family.
- Kos Harris
- Wilberforce Boggs

#### Section 3:

- Alfred Bitting
- Richard Cogdell
- Lucy Greenway
- Henry Vigus
- Darius Munger
- John B Carey
- Louise and Roland P Murdock
- Edwin Bird Allen
- John Oak Davidson
- Gov. William E Stanley
- Coler Sim
- Jacob McAfee
- Henry Van Leu

### Ok, then where is Jesse Chisholm?

He was buried where he died, in Kingfisher, Ok.

### Wait, where is J. R. Mead?

Mr. Mead is buried in a family mausoleum, at Maple Grove. His first wife is buried in Davenport, IA (moved from Towanda); his second wife is buried at Highland. His third wife (Fern) remarried, and is also buried at Maple Grove but with her second husband.

### Section 4:

- William Sternberg
- Finlay Ross
- Sidney Toler
- Enoch Dodge
- Mary Peck Smith
- Emma Smith Goodyear
- Millie and Wesley Hodge
- Richard Robinson’s descendants (He was the only African American signer of the Wichita Charter.)
- Abraham McAfee
- Dr. F. O. Miller
- Baby Ida Herman—1908
- Many Founders of the First Presbyterian Church

### Section 5:

- A. Price Woodard, Jr
- Rev. H. T. Sims
- 1965 Piatt Street Crash – 9 victims
- Infants, African American civilians and soldiers, and unknown persons are interred here and Potter’s Field

### Is there actually a ‘colored’ section?

No. However, the majority of section 5, and many of the burials at the north of sections 3 and 4 are African American.

### Are there Civil War veterans buried here?

Yes, both Union and Confederate.

### What is the Jewish Cemetery?

Congregation Emmanu-El owns the land known as the Jewish Cemetery at Highland. The first burial was of Anna Arnstein, in 1885. This is an active Cemetery so no tours are given except by the congregation itself.

**How has vandalism affected the cemetery?** There have been at least 200 gravestones have been destroyed in the last decade.

### CITY CONTACTS:

#### Who do I call for maintenance information?

The City of Wichita maintains the grounds here and at Jamesburg Park Cemetery. Their number is 268-4553, and Lee Ann Sack is the contact.